

SECTION C-C

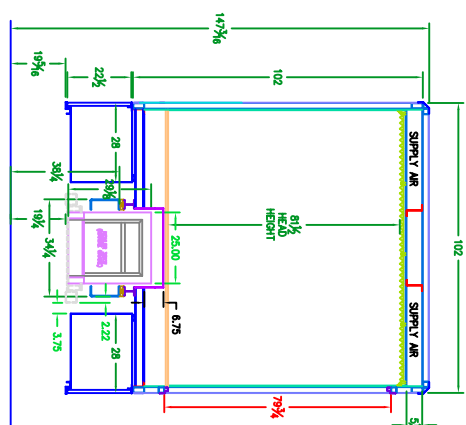

SECTION B-B

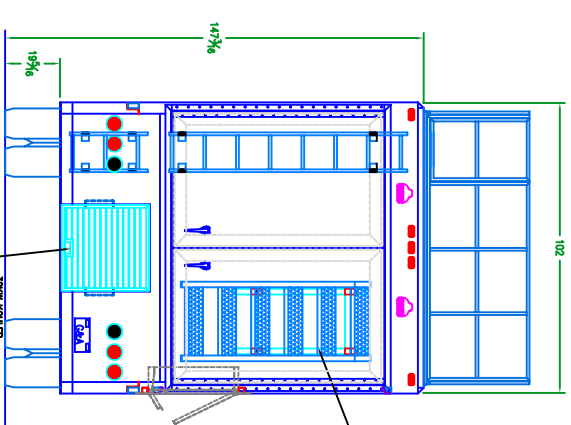

REAR VIEW

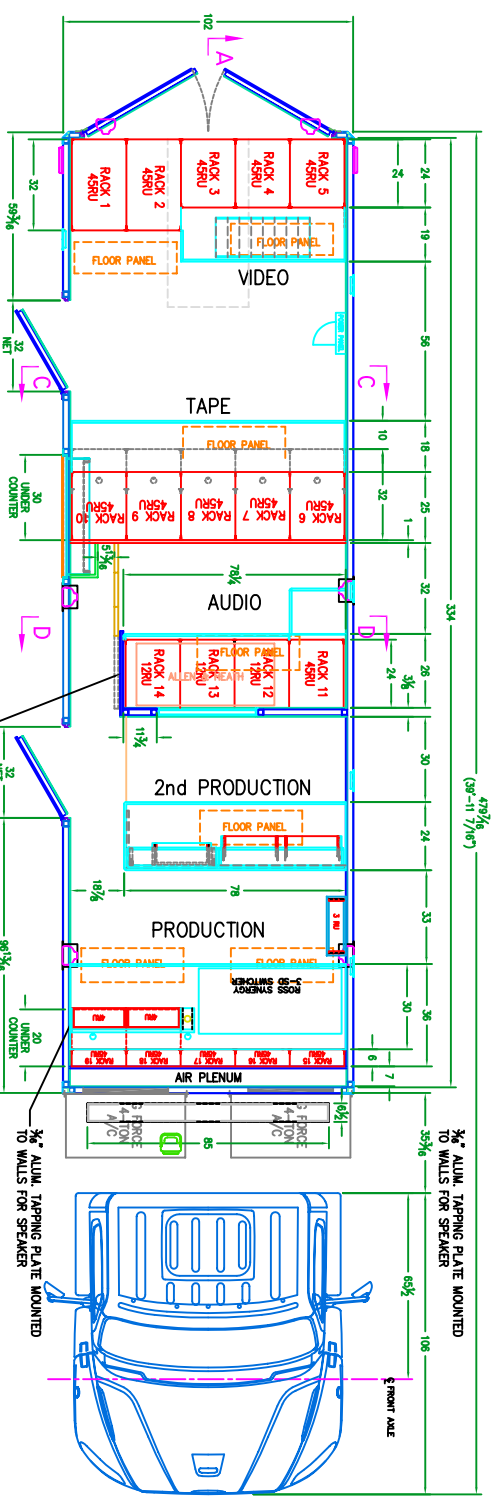

PLAN VIEW

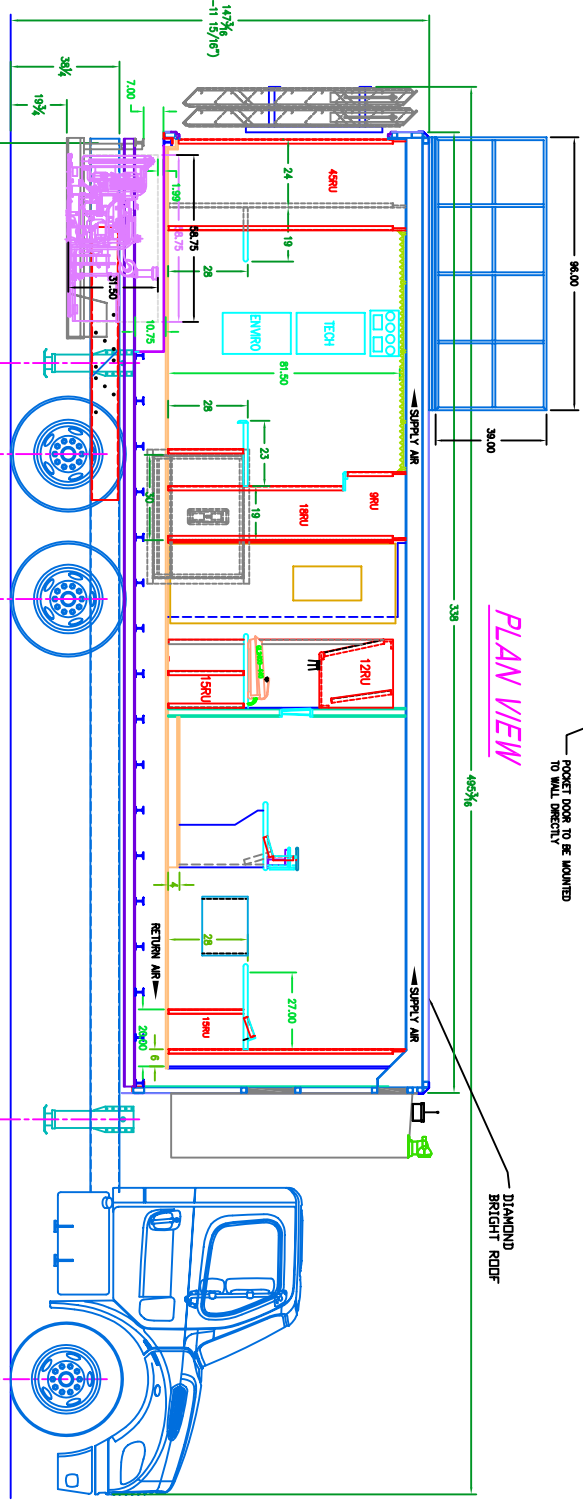

SECTION A-A

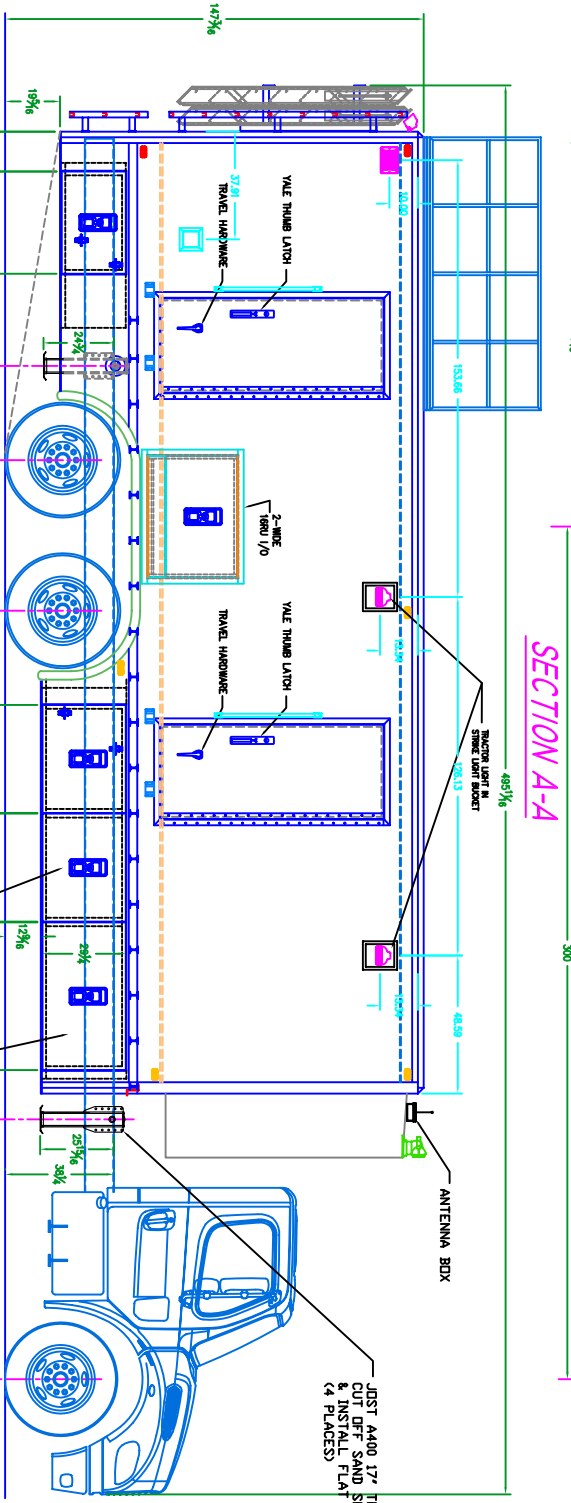

CURBSIDE VIEW

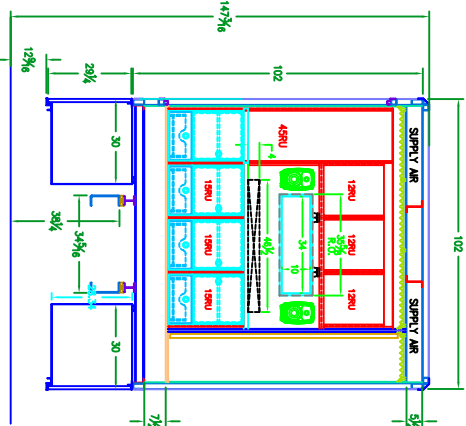

SECTION D-D

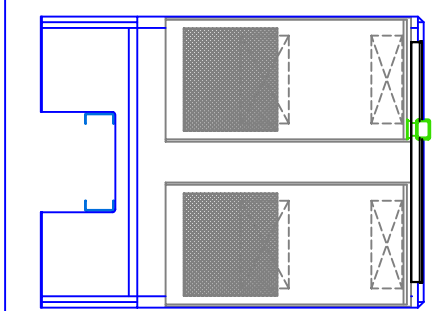

#	DATE	REVISIONS	DWN BY	FINAL	DATE
				APPROVED BY	
				GERLING & ASSOCIATES	
				CLIENT	
				ENGINEERING	

THIS DRAWING AND ALL INFORMATION CONTAINED HEREIN, IS THE PROPERTY OF GERLING AND ASSOCIATES AND SHALL BE THE PROPERTY OF GERLING AND ASSOCIATES. NO PART OF THIS DRAWING OR INFORMATION SHALL BE REPRODUCED OR TRANSMITTED IN ANY FORM OR BY ANY MEANS, WITHOUT THE EXPRESS WRITTEN CONSENT OF GERLING AND ASSOCIATES.		CLIENT <b>C. S. N.</b> DRAWN BY <b>J.D.</b> DATE <b>02/05/07</b> CHECKED BY <b>DATE</b> APPROVED BY <b>DATE</b> SCALE <b>1" = 1'</b>	GERLING AND ASSOCIATES TRUCK LAYOUT COLUMBUS SPORTS NETWORK DRAWING NO. PROJECT #591 SHEET 1 OF 2
---	--	---	--